

CZAMANINEK
POWER IN QUALITY

PRODUCT CATALOG



**PERFECTION AT EVERY
STAGE OF CONSTRUCTION**

INSPIRED BY NATURE | DESIGNED WITH PASSION

www.czamaninek.pl

Expanded clay aggregate - a warm and healthy eco-friendly material

100% Natural



Expanded clay aggregate is made from clay without the addition of artificial ingredients, making it a 100% natural and safe material.



The porosity of expanded clay aggregate allows for free airflow and water vapor diffusion, facilitating natural moisture regulation.



Expanded clay aggregate easily allows the passage of moist air without retaining water in its structure, which is why it is naturally a dry material.



The lightweight of expanded clay aggregate makes it an excellent insulator, allowing it to retain heat in our homes during freezing winter days and nights.



SUBSTRUCTURE

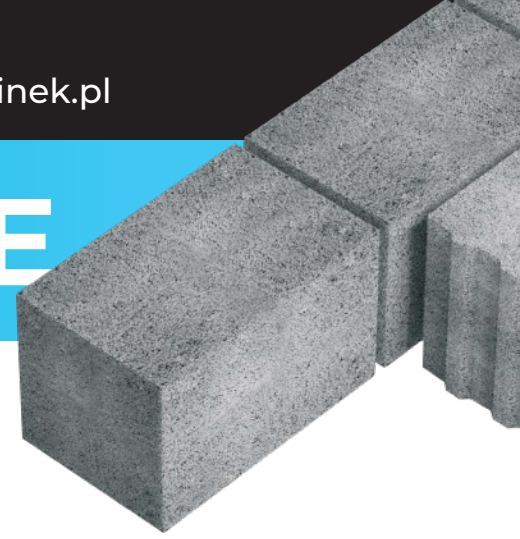

INSPIRED BY NATURE | DESIGNED WITH PASSION



Liatop Start

substructure block, expanded clay concrete,
The basic foundation block in the Czamaninek system.
10,5 pcs/m²

 10 MPa  (48 pcs/plt)  W. 24/L. 37,5/H. 24 cm  26.5-28 kg



Block BF-38

Lightweight expanded clay substructure block

A solution for passive houses and single-story buildings where thermal insulation of the foundation wall is crucial. 10,5 pcs/m²

 5 MPa  (48 pcs/plt)  W. 24/L. 38/H. 24 cm  22-24 kg

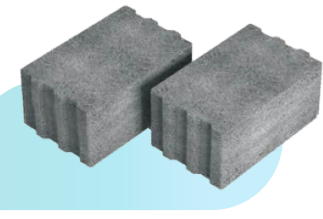

Block BS Ring beam

Complementary expanded clay concrete foundation block

Expanded clay concrete foundation block with a height of 12 cm, which can be used both as a basic foundation wall and its topping.

 10 MPa  (80 pcs/plt)  W. 24/L. 38/H. 12 cm  14 kg

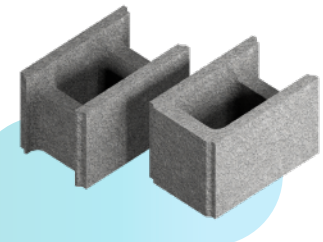

Lightweight concrete shuttering block

The shuttering block is called the filling or flooding block that fulfills the role of permanent formwork. It is used in the construction of foundation walls, load-bearing walls, and residential buildings and economic, poles and pillars, retaining walls, etc.

 8 MPa  (70 pcs/plt)  W. 37,5/L. 24/H. 25 cm  16 kg

BLOCK ADHESIVE

- Made of lightweight concrete [expanded clay concrete]
- For use indoors and outdoors
- High strength
- Excellent adhesion and flexibility
- Joint thickness 5-10mm
- Frost resistance



Single-family houses



Public utility buildings



Multistory residential buildings
Development investments

WALLS



INSPIRED BY NATURE | DESIGNED WITH PASSION



Block Termo Czamaninek 36,5

Lightweight concrete wall block for interior and exterior walls. A proposal with the best thermal properties and increased thickness of 36,5 cm, allowing for reduced thermal insulation thickness.

 2 N/mm²  (54 pcs/plt)  W. 36.5/L. 24/H. 25 cm  15.86 kg

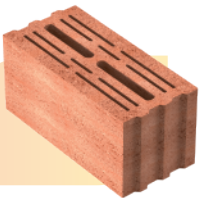

Block AKU K5 50

Lightweight concrete wall block for interior and exterior walls. The enlarged version of AKU K5 block with a length of 50 cm, designed primarily for single-family residential buildings with structural walls of 24 cm thickness.

 2 N/mm²  (60 pcs/plt)  W. 24/L. 50/H. 24 cm  21 kg

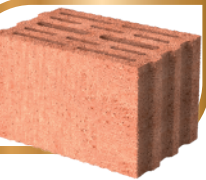

Block AKU K5 37,5

The lightweight concrete wall block for interior and exterior walls. The foundation of the AKU wall system with a wall thickness of 24 cm.

 4 N/mm²  (70 pcs/plt)  W. 24/L. 37.5/H. 24 cm  16.5 kg

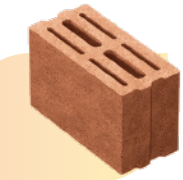

Block AKU K3 18

The lightweight concrete wall block for interior and exterior walls. The AKU block version with three rows of cells, serving as the basis for the system to construct buildings with structural walls of only 18 cm thickness

 4 N/mm²  (84 pcs/plt)  W. 18/L. 37.5/H. 24 cm  17 kg

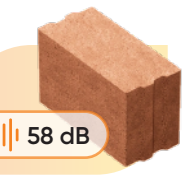

Acoustic brick 18

Lightweight concrete wall block with enhanced acoustic insulation properties. Solid masonry unit dedicated for constructing load-bearing and non-load-bearing walls.

 58 dB

 10 N/mm²  (50 pcs/plt)  W. 18/L. 38/H. 24 cm  28.5 kg

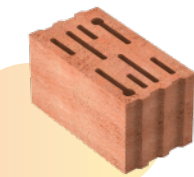

Block AKU EKO PLUS

Lightweight concrete block with increased strength. Perfectly fulfilling the role in places of increased loads.

 8 MPa  (50 pcs/plt)  W. 24/L. 37.5/H. 24 cm  26-28 kg

Lightweight and thermal insulating block

By harnessing the possibilities offered by expanded clay, we have created a block that is as lightweight and thermally insulating as gas concrete, while being natural and eco-friendly like ceramics. The most breathable brick on the market

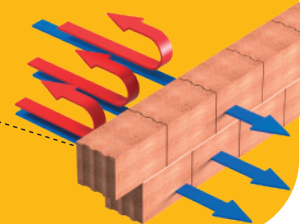

Single-family houses



Public utility buildings



Multistory residential buildings
Development investments

WALLS

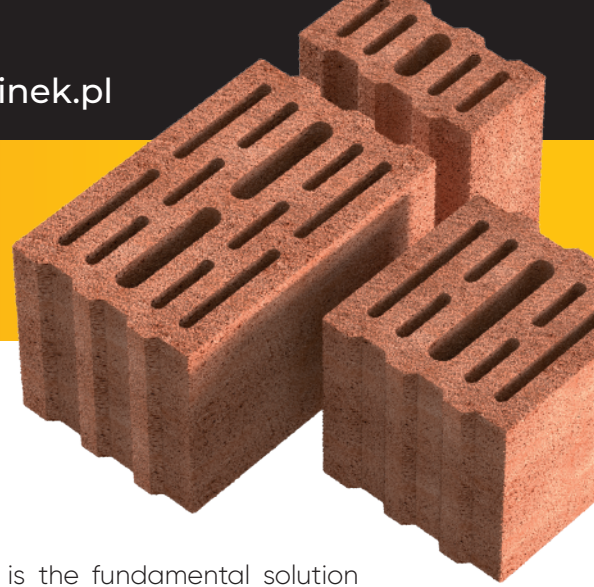

INSPIRED BY NATURE | DESIGNED WITH PASSION

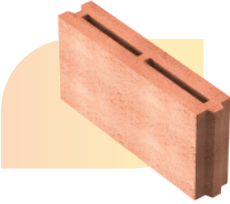

Termo 12 (perforated)

Partition wall block. Termo 12 with perforations is the fundamental solution dedicated to partition walls, enabling rapid construction without vertical tongue and groove joints.

2 N/mm² (126 pcs/plt) W. 12/L. 50/H. 24 cm 9.38 kg

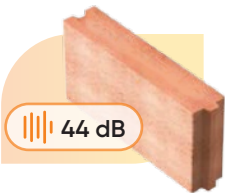

Termo 12 (solid)

Partition wall block. The full version of the product line for partition walls is characterized by better acoustic performance and increased flexibility when routing complex installations in the grooves.

2 N/mm² (108 pcs/plt) W. 12/L. 50/H. 24 cm 12.56 kg

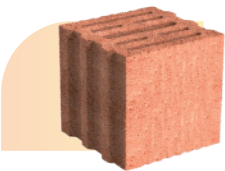

Complementary Aku K5 wall block 25

The lightweight concrete wall block for interior and exterior walls. The foundation of the Aku wall system. Complementary element.

4 N/mm² (105 pcs/plt) W. 24/L. 25/H. 24 cm 11 kg

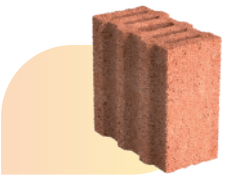

Complementary Aku K5 wall block 12.5

The lightweight concrete wall block for interior and exterior walls. The foundation of the Aku wall system. Complementary element

4 N/mm² (210 pcs/plt) W. 24/L. 12.5/H. 24 cm 5.5 kg



Block - footing

Complementary lightweight concrete wall block. Complementary block with increased compressive strength, designed for use at the bearing points of lintels and tie beams, as well as under the ceiling ring beam.

8 N/mm² (100 pcs/plt) W. 24/L. 12.5, 25, 37.5/H. 12 cm 4.2-12.6

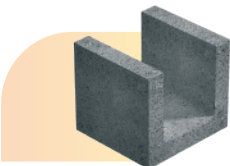

The crown block U24

Designed for constructing the ring beam enclosure on walls with a thickness of 24 cm

3 pcs/mb (80 pcs/plt) W. 24/L. 33/H. 24 cm 9.58 kg

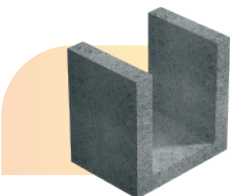

The crown block U31

Designed for constructing ring beam enclosures on walls with a thickness of 24 cm

3 pcs/mb (60 pcs/plt) W. 24/L. 33/H. 31 cm 15.02 kg



Single-family houses



Public utility buildings



Multistory residential buildings
Development investments

LINTELS

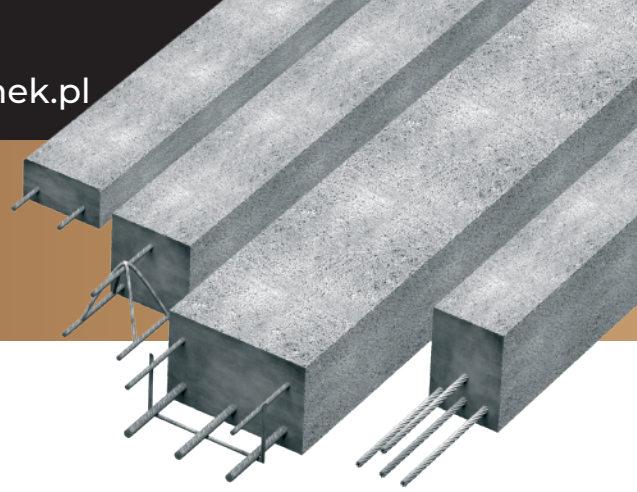

INSPIRED BY NATURE | DESIGNED WITH PASSION



PN 11.5x11.5 - The lintel made of lightweight concrete.

Reinforced concrete lintels made of lightweight concrete LC 30/33 for walls with a thickness of 24cm and 36.5cm.

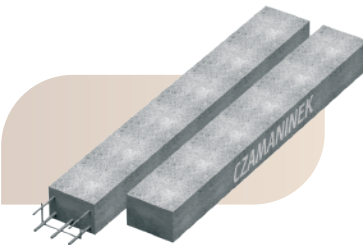
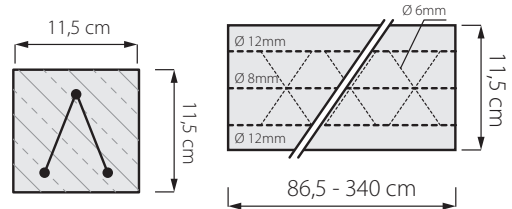

PN 17.5x11.5 - The lintel made of lightweight concrete.

Reinforced concrete lintels made of lightweight concrete LC 30/33 for walls with a thickness of 18cm, 36.5cm, and 24cm. Dedicated for use in the installation of external and recessed roller shutters.

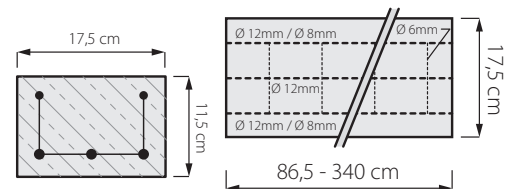

Lintels NLC 11.5x5.5

Reinforced concrete lintels for use in non-load-bearing walls with a thickness of 12 cm

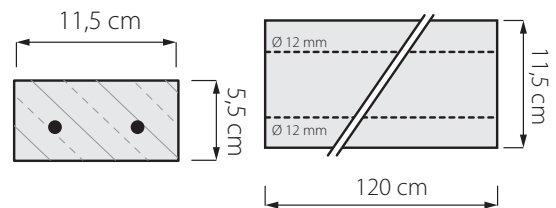

Length of the lintel (cm).	Weight of the lintel (kg).	Number of layers/pieces per pallet	
		11.5/11.5	17.5/11.5
86,5	18	6/48	8/40
99,0	21	6/48	8/40
124,0	25	6/48	6/30
149,0	31	6/48	6/30
174,0	37	4/40	5/25
200,0	42	4/32	5/25
220,0	46	4/32	4/20
249,0	54	3/24	4/20
280,0	58	3/24	3/15
310,0	68	2/16	3/15
340,0	74	2/16	3/15

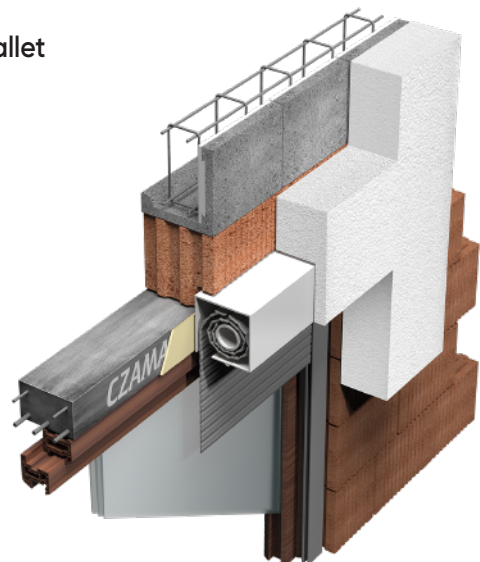

Single-family houses



Public utility buildings



Multistory residential buildings
Development investments

SHAPES

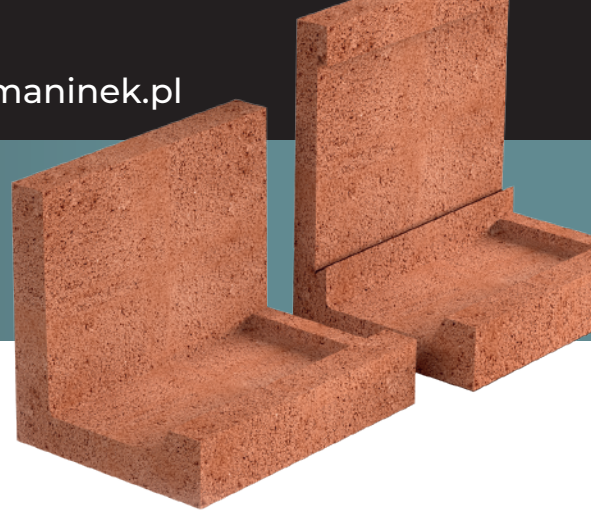

INSPIRED BY NATURE | DESIGNED WITH PASSION

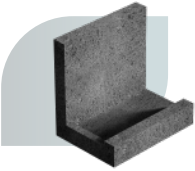

Crown block KLB L 24

Designed for constructing ring beam enclosure on walls with a thickness of 24 cm. The constructional height of the ceiling is 24 cm

3 pcs/mb (80 pcs/plt) W. 24/L. 33/H. 31.5 cm 11.56 kg

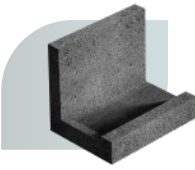

Crown block KLB L 24/27

Designed for constructing ring beam enclosures on walls with a thickness of 24 cm.

3 pcs/mb (96 pcs/plt) W. 24/L. 33/H. 27 cm 10.82 kg

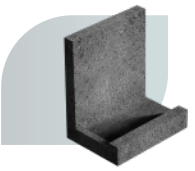

Crown block KLB L 24/37.5

Designed for constructing ring beam enclosures for ceilings with a constructional height of 30 cm. On wall 24 cm.

3 pcs/mb (80 pcs/plt) W. 24/L. 33/H. 37.5 cm 13.2 kg

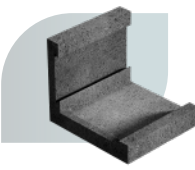

Crown block KLB L 36.5

Designed for constructing ring beam enclosures on walls with a thickness of 36.5 cm. The constructional height of the ceiling is 24 cm

3 pcs/mb (80 pcs/plt) W. 36.5/L. 33/H. 31 cm 15.68 kg



Crown block KLB L 18

Designed for constructing ring beam enclosures on walls with a thickness of 18 cm. The constructional height of the ceiling is 24 cm.

3 pcs/mb (100 pcs/plt) W. 18/L. 33/H. 31.5 cm 10.74 kg

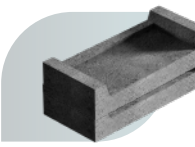

Crown block KLB C 24

Designed for constructing ring beam enclosures with double-sided support for the ceiling on a wall with a thickness of 24 cm

4 pcs/mb (192 pcs/plt) W. 24/L. 25/H. 7.5 cm 5.42 kg

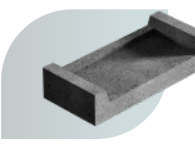

Crown block KLB C 18

Designed for constructing ring beam enclosures with double-sided support for the ceiling on a wall with a thickness of 18 cm.

4 pcs/mb (240 pcs/plt) W. 18/L. 25/H. 7.5 cm 4.06 kg

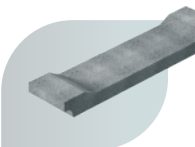

Separating rib shape

Recommended use in ribbed ceilings with a span exceeding 4 m

KZ 70 (120 pcs/plt) W. 62/L. 12/H. 9 cm 6.28 kg

KZ 60 (280 pcs/plt) W. 52/L. 12/H. 9 cm 4.86 kg



Single-family houses



Public utility buildings



Multistory residential buildings
Development investments

CEILINGING



INSPIRED BY NATURE | DESIGNED WITH PASSION

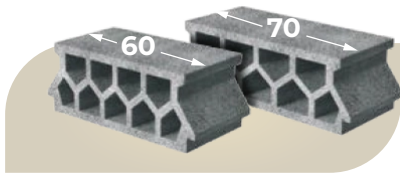

Czamaninek 60EU i 70EU

Ceiling system with a construction height of 24 cm and beam spacing of 60 and 70 cm. The most frequently chosen ceiling from the Czamaninek company. The total construction height including the concrete topping is 24 cm, and the spacing between the beams is 60 or 70 cm.

☑ 60EU W. 52/H. 20/L. 24 cm

☑ 70EU W. 62/H. 20/L. 24 cm

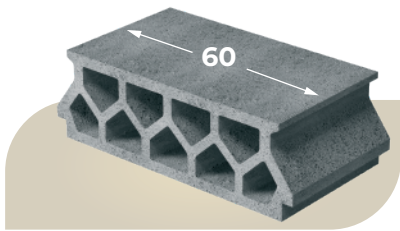

Czamaninek K-9/16 60EU

The 9-cavity floor block is designed for constructing densely-ribbed ceilings with a beam spacing of 60 cm. The constructional height of the ceiling is 20 cm.

☑ W. 52/H. 16/L. 24 cm

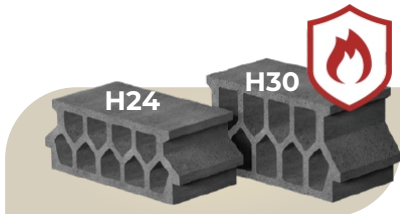

fire-resistant ceiling Czamaninek 60EU R60

A floor system with a constructional height of 24 and 30 cm, with increased fire resistance. A floor system with confirmed R60 fire resistance by ITB tests. Available in two variants.

☑ H24 W. 52/H. 20/L. 24 cm

☑ H30 W. 52/H. 26/L. 24 cm

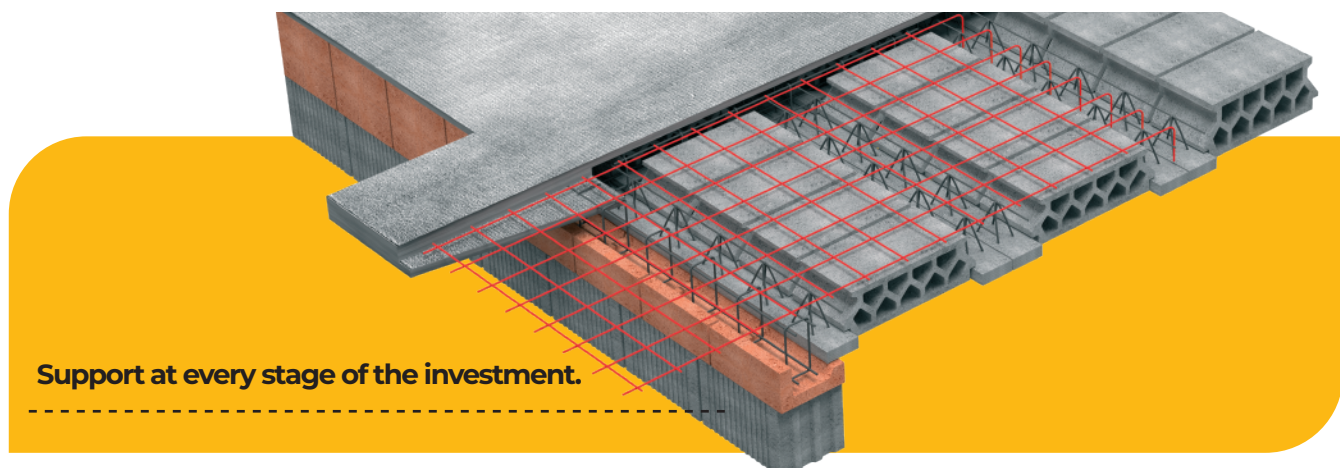

Support at every stage of the investment.



Single-family houses



Public utility buildings



Multistory residential buildings
Development investments

CONSTRUCTION CHEMICALS INSULATION SYSTEM



INSPIRED BY NATURE | DESIGNED WITH PASSION



Adhesive for clay aggregate concrete blocks and bricks

The solution is dedicated to precisely crafted lightweight concrete wall elements. Czamaninek adhesive is a complement to the wall system. We have created a solution that allows achieving maximum compressive strength of the wall while maintaining appropriate workability



Czamaninek Cz 19

Czamaninek plastering mortar is used as an undercoat layer between the load-bearing substrate and the top layer (finish coat), such as lightweight Czamaninek machine plaster.



Czamaninek Cz 17

The lightweight cement-lime machine plaster. Czamaninek mortar is a lightweight plaster mortar designed for machine application for traditional interior plastering. It can also be applied manually.



Czamaninek Cz 1

The adhesive mortar for attaching polystyrene boards. Czamaninek adhesive mortar is a cement-based adhesive mortar designed for attaching polystyrene boards to the substrate in the Czamaninek system. It can be used on all typical, load-bearing, and even mineral substrates such as concrete, renders, brick walls, lightweight concrete blocks.



Czamaninek Cz 2B

The white adhesive mortar for creating the reinforcement layer and attaching polystyrene boards. The mortar is a white, cement-based adhesive mortar designed for creating the reinforcement layer in the Czamaninek system.



Styrofoam Super Fasada Cz 038

EPS (Expanded Polystyrene) foam boards. Used in applications requiring the transfer of low mechanical loads, especially for thermal insulation purposes.



Primer Czamaninek

The Czamaninek primer is designed for preparing the substrate before applying mineral, mosaic, acrylic, and siloxane plasters.



Single-family houses



Public utility buildings



Multistory residential buildings
Development investments

CHIMNEYS and VENTILATION

INSPIRED BY NATURE | DESIGNED WITH PASSION



Schiedel RONDO PLUS

Universal and particularly useful chimney systems. Suitable for solid, liquid, and gaseous fuels, low and high-temperature flue gases



Schiedel STABIL

Schiedel Stabil is a three-layer insulated chimney system designed for venting dry combustion gases from solid fuel heating devices.



Schiedel DUAL

Schiedel Dual is an innovative multi-functional chimney that allows venting of combustion gases from solid, gas, and oil-fired boilers, including condensing boilers.



Schiedel QUADRO PRO

Schiedel Quadro Pro is the latest air-flue system in Schiedel's offering, designed for venting combustion gases from gas and oil-fired appliances in residential buildings.



Ventilation brick W-1

1 ventilation duct

(140 pcs/plt) **KG** 9 kg

W. 19/L. 24/H. 24 cm



Ventilation brick W-2

2 ventilation ducts

(84 pcs/plt or 50 pcs/plt) **KG** 14 kg

W. 24/L. 38/H. 24 cm
or W. 24/L. 36/H. 33 cm

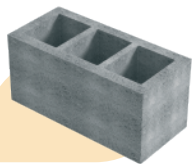

Ventilation brick W-3

3 ventilation ducts

(56 pcs/plt) **KG** 22 kg

W. 24/L. 52/H. 24 cm



Ventilation brick W-4

4 ventilation ducts

(28 pcs/plt) **KG** 28 kg

W. 25/L. 64/H. 24 cm



Single-family houses



Public utility buildings



Multistory residential buildings
Development investments

We build all over Poland!



CZAMANINEK

Manufacturer of building materials Sp. z o.o.
Czamaninek 3, 87-875 Topólka



The sales department



Witold Rydzynski

THE REGIONAL DIRECTOR
Trójmiasto, Grudziądz, Brodnica, Elbląg, Olsztyn
- 609 22 88 05
- witold.rydzynski@czamaninek.pl



Marcin Janke

THE REGIONAL DIRECTOR
Poznań, Konin, Gniezno, Września, Kalisz, Turek
- 725 648 005
- marcin.janke@czamaninek.pl



Paweł Mierzwiński

THE REGIONAL DIRECTOR
Warszawa, Łódź, Skierniewice, Kutno
- 501 274 999
- pawel.mierzwinski@czamaninek.pl



Radosław Wojdak

THE REGIONAL DIRECTOR
Bydgoszcz - Północ, Solec Kujawski, Sępólno Krajeńskie, Koronowo, Niemcz, Człuchów, Chojnice, Świecie, Tuchola, Chełmno, Toruń, Wąbrzeźno, Golub-Dobrzyń, Topólka, Izbica Kujawska
- 723 419 476
- radoslaw.wojdak@czamaninek.pl



Adam Sadowski

THE REGIONAL DIRECTOR
Suwałki, Giżycko, Ełk, Kętrzyn, Mrągowo, Szczytno, Białystok, Siedlce, Lublin, Chełm, Rzeszów
- 784 657 826
- adam.sadowski@czamaninek.pl



Łukasz Sandecki

THE REGIONAL DIRECTOR
Bydgoszcz - Południe, Złotniki Kujawskie, Łochowo, Szubin, Nakło nad Notecią, Piła, Wałcz, Radziejów, Mogilno, Trzemeszno, Żnin, Inowrocław, Barcin, Gniewkowo
- 887 228 880
- lukasz.sandecki@czamaninek.pl



Logistics



We can come to any location!

- We have a fleet of heavy-duty trucks equipped with specialized four-way Moffett forklifts, which can handle any terrain with ease.

- Trust us if you need fast and secure transportation.

Our qualified staff will take care of delivering materials to your location according to your requirements.



BE THE LION OF YOUR OWN CONSTRUCTION

Do you have a project?
We will recalculate
it using our technology!



MANUFACTURER OF BUILDING MATERIALS

Czamaninek 3, 87-875 Topólka

tel. 54 286 94 44 / 54 286 90 18

NIP: 889 151 97 87, REGON: 385698798

KRS: 0000832005



facebook.com/czamaninek



[/czamaninek-nowoczesne-systemy-budowlane](https://linkedin.com/company/czamaninek-nowoczesne-systemy-budowlane)

Contact us
www.czamaninek.pl